

LLOYD

Acitvator Hylo

OPERATION & PARTS



Lloyd Table Company
102 W. Main Street * Lisbon, IA 52253
Phone 319-455-2110 Fax 319-455-2166
Website www.lloydtable.com
Email sales@lloydtable.com
Call Toll Free 1-800-553-7297



CONTENTS

<u>OPERATIONS</u>	<u>PAGE</u>
Safety and Maintenance.....	1 - 2
Breaker Power Switch.....	3
Foot Pedal Control.....	3
Automatic Tilt Feature.....	4
Speed Control.....	4
<u>PARTS / ASSEMBLY</u>	<u>PAGE</u>
Activator Frame.....	5-6
Electrical Assembly.....	7
Hydraulics Assembly.....	8
Cushions and Covers.....	9
Electrical Schematic.....	10-13

Table Serial Number _____

WELCOME!!

Lloyd Table Company, a proud supporter of today's chiropractors, has established the finest line of chiropractic tables in the world. Table products unique in versatility and function, designed to meet your needs.



SAFETY

Concerned for a safe working and treatment environment, Lloyd Table Company asks that you follow the safety tips below.

- * Be aware of **Caution** and **Warning** labels posted throughout the table before operating any functions.

- * Everyone operating the table needs to read the manual and familiarize themselves with all its functions before operating the table with patient on it.

- * A patient should never be unattended, when lying on the table.

- * The patient should be positioned at or near the center of the table.

- * There should be no more than one operator at the controls.

- * Unplug the power cord from outlet before replacing fuses, or performing any electrical work.



MAINTENANCE

The following steps should be performed on a regular basis to maintain your Lloyd table in a smooth operating condition and to assure its long life and top quality appearance.

- * An initial inspection and periodic future inspections should be made to insure that nuts and bolts have not loosened in shipping or during daily operations.
- * Your Lloyd table should be lubricated every **six months**. Parts to be lubricated are all pivot points, and metal to metal sliding mechanisms.
- * The cushions should be cleaned daily with a mild soap & warm water solution to remove body oils.
- * Chrome and Powder Coat parts should be cleaned on a weekly basis for appearance.
- * The hydraulic fluid recommended for the pump, is a lubriplate HO1 hydraulic oil, and should be checked on a yearly basis.

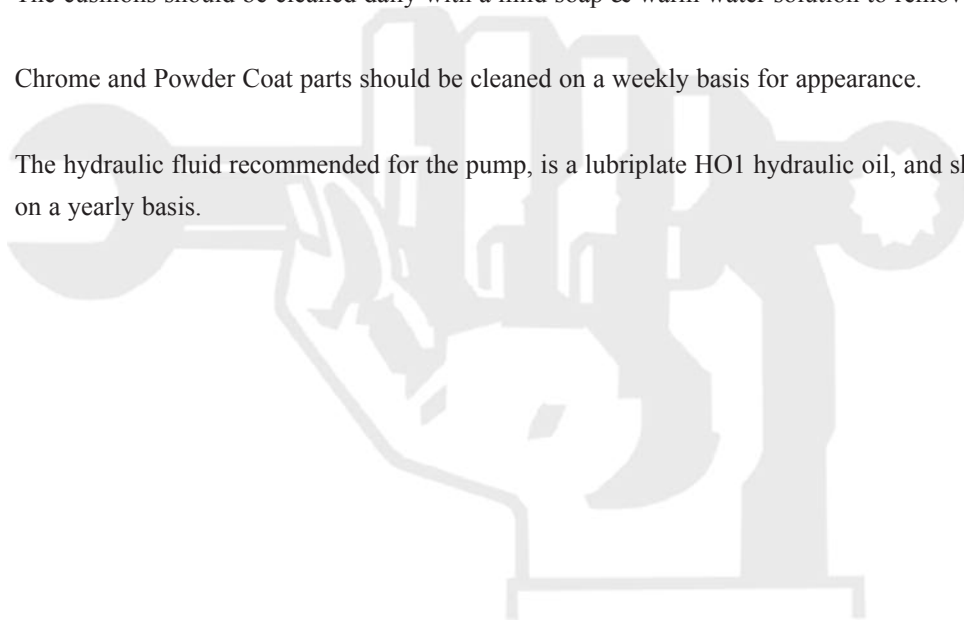

Breaker Power Switch



A Power Breaker Switch (#1) is located on the front left side of the base frame. The breaker shuts off power to the table do to over loads and power surges. To reset the breaker, unplug the power cord from the wall outlet, then push the rocker switch back to the other side.

The table's electrical circuit board is also equipped with a fuse protector. The circuit board is located under the cover on the front left side.

! WARNING: UNPLUG THE POWER CORD FROM THE ELECTRICAL WALL OUTLET BEFORE REPLACING THE FUSE OR RESETTING BREAKER, TO AVOID INJURY.

Foot Pedal Control

Directional Pedal (Black)

The directional pedals raise and lower the table thru it's hylo function.

The directional pedals can be operated in manual or auto mode (auto-optional Automatic Tilt Feature).

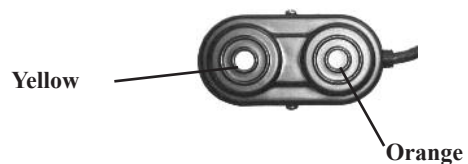

Non-Corded Side - Lowers the table from Vertical to horizontal.

Corded Side - Raises table from horizontal to Vertical.

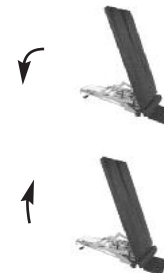

AUTOMATIC TILT FEATURE

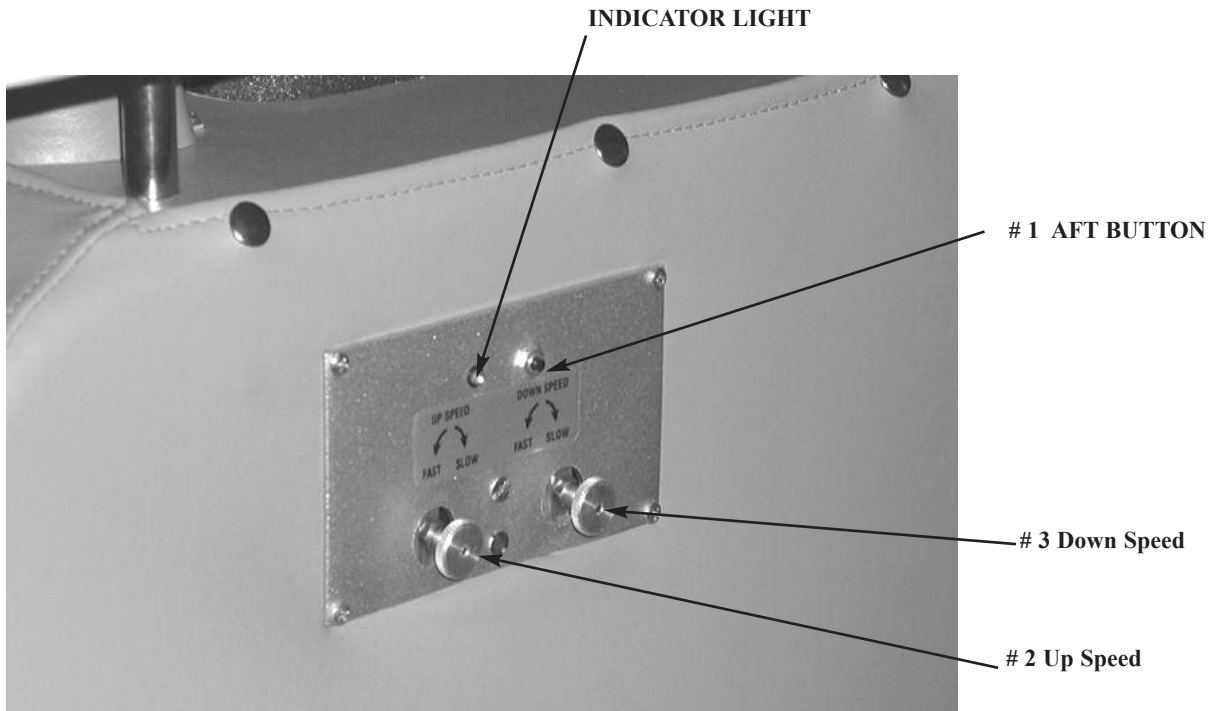

Automatic Tilt Feature (AFT)

An Optional feature of the Activator Hylo is the ATF. Pressing the AFT Button (#1) on the left side of the control panel will switch the AFT mode On and Off. A green emitting light will indicate that the table is in the AFT mode. In the AFT mode, the Directional Control Pedal is pushed to activate the table. Once activated released the pedal and the table will continue to run thru the operation with out having to hold the pedal down.

Speed Control

The speed of the table going up or coming down may be controlled with the “Up Speed” (#2) and “Down Speed”(# 3) Flow Control Knobs. Located on the left side of the table, adjust the speed by turning in a clockwise or counter-clockwise direction:

A. Clockwise - Slows speed down.

B. Counter Clockwise - Increases the speed

ACTIVATOR FRAME ASSEMBLY

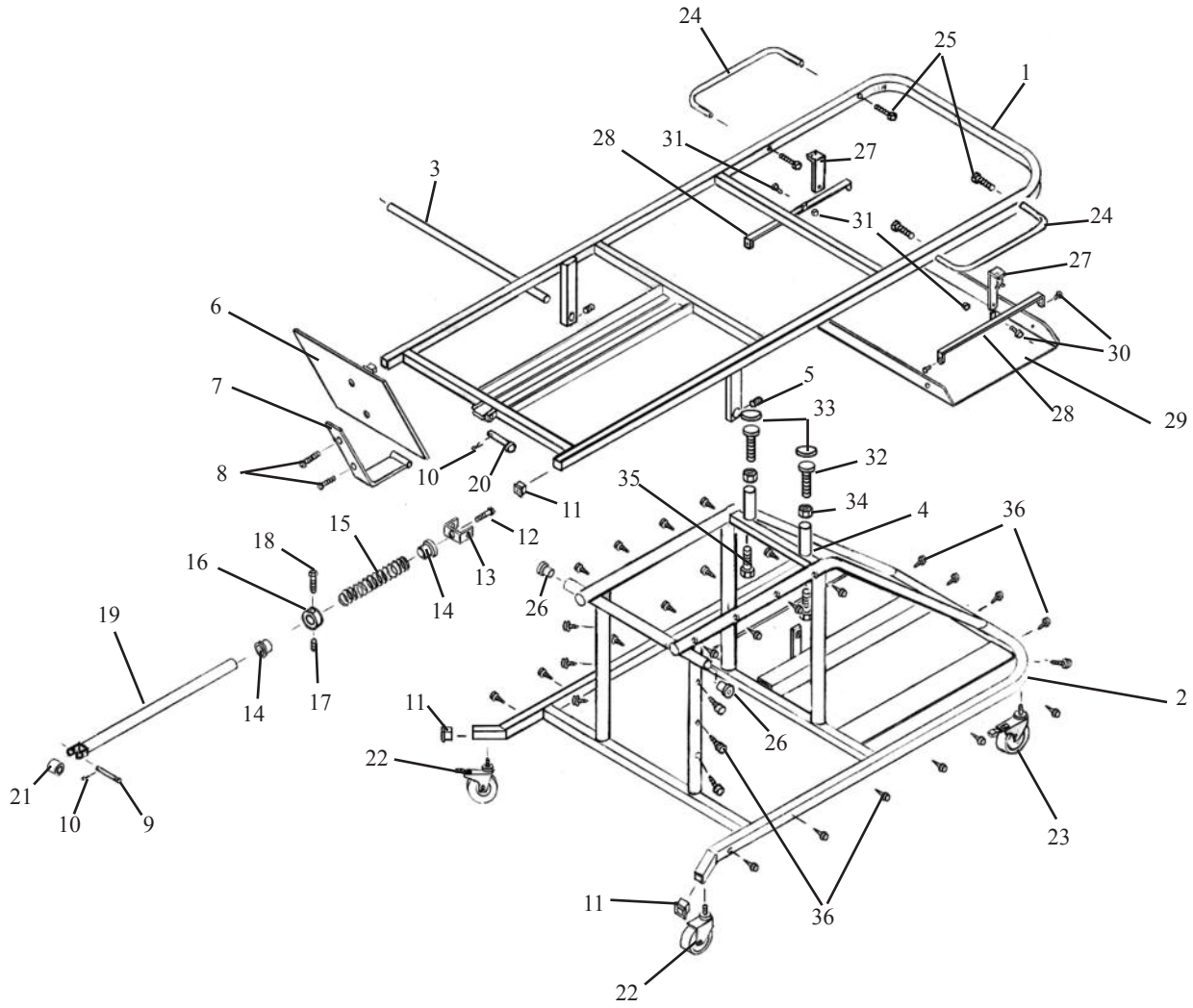

ACTIVATOR FRAME ASSEMBLY

ITEM	PART NO.	DESCRIPTION	QTY.
1	55239	TOP FRAME ASS'Y	1
2	55238	BASE FRAME ASS'Y	1
3	55251	AXLE ROD, ½ RD X 21 ½	1
4	55292	STABILIZER POST	1
5	22110	SET SCREW, ¼-20UNC X 1/4	4
6	55260	FOOT PLATE	1
7	55262	BRACKET ASS'Y	1
8	22073	MACHINE SCREW, 5/16-18UNC X ½	2
9	22690	CLEVIS PIN, 3/8RD. X 2	1
10	22640	COTTER PIN, 3/32 X 1	2
11	24414	PLASTIC CAP	4
12	20510	HEX HD BOLT, ½-20UNC X 1 ¼	1
13	55250	CYLINDER YOKE	1
14	22857	SLIDE BUSHING	2
15	30860	COMPRESSION SPRING	1
16	55256	COLLAR, 1 1/4ID X 1 3/4OD	1
17	22230	SET SCREW, 5/16-18 UNC X 1 ¼	1
18	20222	HEX HD BOLT, 5/16-18 UNC X 1 ¼	1
19	55254	SLIDE ARM ASS'Y	1
20	22692	CLEVIS PIN 3/8 X 3.00	1
21	55252	ROLLER 1 ½ DIA	1
22	24445	CASTER WHEEL	2
23	24440	CASTER WHEEL (BRAKE)	2
24	55282	HANDLE	2
25	20361	HEX. HEAD BOLT, 3/8-16UNC X 1 ¾	4
26	22888	BUSHING	2
27	55288	EXTENSION ARM	2
28	55285	HANGER ASS'Y	2
29	699210	TRAY	1
30	22472	PAN HD. SCREW, #10 X ½	6
31	21447	ACORN NUT, #10-24UNC	6
32	20372	ELEVATOR BOLT, 3/8-16UNC X 1 1/2	2
33	24409	RUBBER CAP	2
34	21210	HEX NUT, 3/8-16UNC	2
35	20362	HEX BOLT, 3/8-16UNC X 1½	2
36	24221	SNAP	32

ELECTRICAL ASSEMBLY

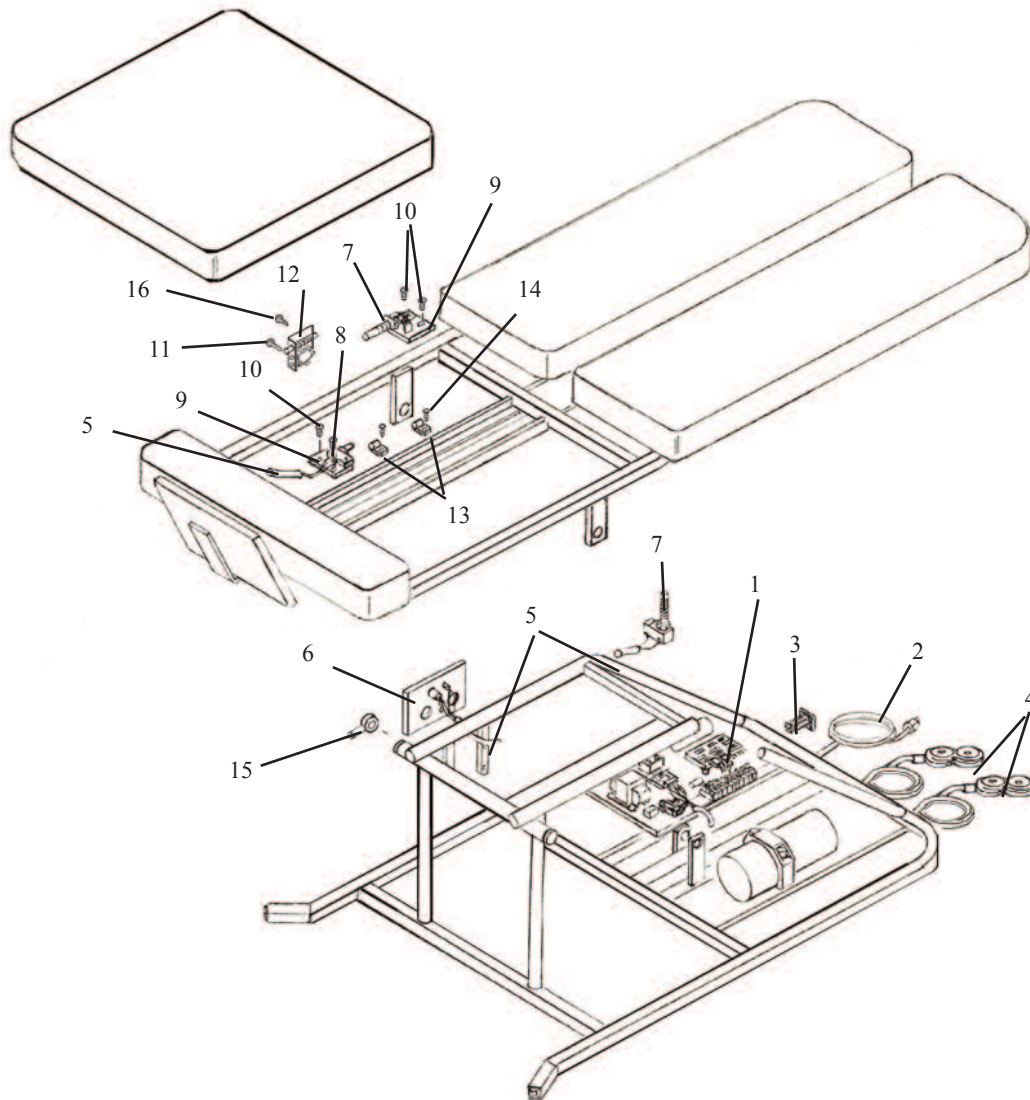

ITEM	PART N0.	DESCRIPTION	QTY.
1a	44996	ELECTRICAL UNIT, (Non-AFT)	1
1b	44997	ELECTRICAL UNIT, (AFT)	1
2	45192	POWER CORD	1
3	35216	CIRCUIT BREAKER, 8 AMP	1
4a	44089	PEDAL ASSEMBLY, DIRECTIONAL CONTROL (Non-AFT)	1
4b	44091	PEDAL ASSEMBLY, DIRECTIONAL CONTROL (AFT)	1
5a	45115	WIRE HARNESS ASS'Y (Non-AFT)	1
5b	45117	WIRE HARNESS ASS'Y, (AFT)	1
6	44001	PANEL ASS'Y, (AFT)	1
7	44050	LIMIT SWITCH (Extender)	2
8	38040	LIMIT SWITCH	1
9	55275	MOUNTING PLATE	2
10	21982	PAN HD. MACHINE SCREW, #8-32 UNC X 1/2	4
11	21976	PAN HD. MACHINE SCREW, #6-32 UNC X 3/4	1
12	38005	TILT LIMIT SWITCH ASS'Y	1
13	35900	TIE CLAMP	2
14	22410	ROUND HD. SCREW, #6 X 1/4	2
15	55291	STOP COLLAR ASSEMBLY	1
16	21979	PAN HD. MACHINE SCREW, #6-32 UNF X 5/8	1

HYDRAULICS

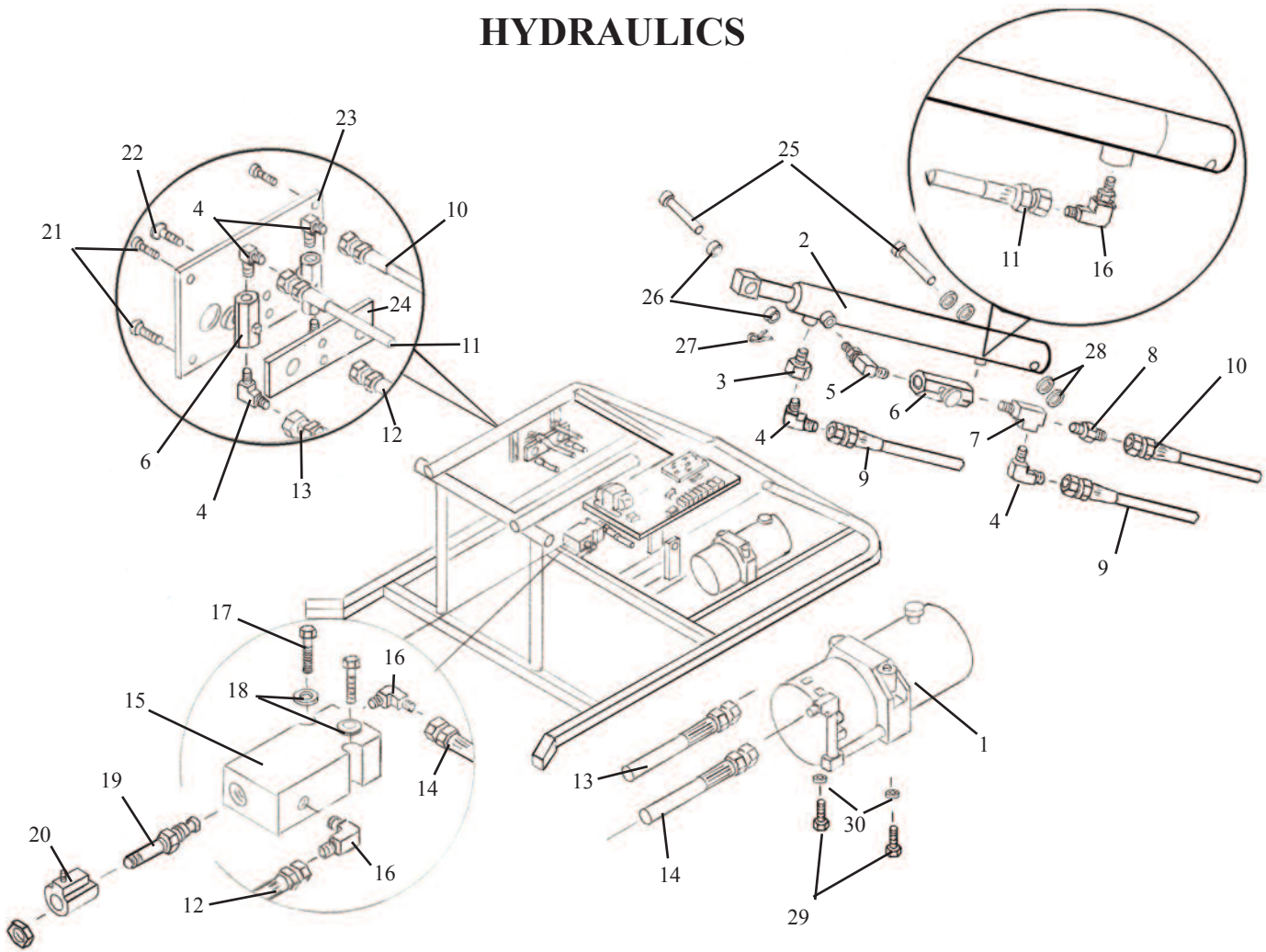

ITEM	PART NO.	DESCRIPTION	QTY.
1	623638	MOTOR ASSEMBLY KIT	1
2	30289	TILT CYLINDER	1
3	23462	ADAPTER FITTING	1
4	23110	FITTING, 90 deg. SWIVEL 1/8 MALE-JIC	5
5	23127	FITTING, 90 deg, 1/8 MALE- PIPE	1
6	23577	CONTROL VALVE	3
7	23210	FITTING, TEE, MALE – FEMALE	1
8	23040	COUPLER, MALE, 1/8 JIC	1
9	45240	HOSE, HYDRAULIC, 3/16 X 12	1
10	45290	HOSE, HYDRAULIC, 3/16 X 22	1
11	45230	HOSE, HYDRAULIC, 3/16 X 17	1
12	45270	HOSE, HYDRAULIC, 3/16 X 18	1
13	45295	HOSE, HYDRAULIC, 3/16 X 27	1
14	45250	HOSE, HYDRAULIC, 3/16 X 16	1
15	23544	VALVE BLOCK, 2 WAY	1
16	23155	FITTING, 90 deg. SWIVEL, MORB –1/4 JIC	3
17	20052	HEX HD. BOLT, 1/4-20UNC X 1 3/4	2
18	21620	FLAT WASHER, 1/4ID X 9/16OD	2
19	23571	DOUBLE POPPET VALVE	1
20	36005	COIL, SOLENOID 24V	1
21	21982	PAN HD SCREW, # 8-32unc x 1/2	4
22	22002	FLAT HD SCREW, # 10-24unc X 3/4	2
23	55300	FRONT PANEL	1
24	55345	BACK PLATE	1
25	22679	CLEVIS PIN 1/2 X 3 1/2	2
26	22915	COLLAR 1/2"	2
27	22640	COTTER PIN, 3/32 X 1.00	2
28	21910	FLATE WASHER, 1/2ID X 1.00 ODD	4
29	20010	BOLT, HEX HD. 1/4-20 UNC X 3/4	2
30	21710	FLAT WASHER, 5/16ID X 11/16OD	2

CUSHION AND COVER ASSEMBLY

(698600 - 699201)

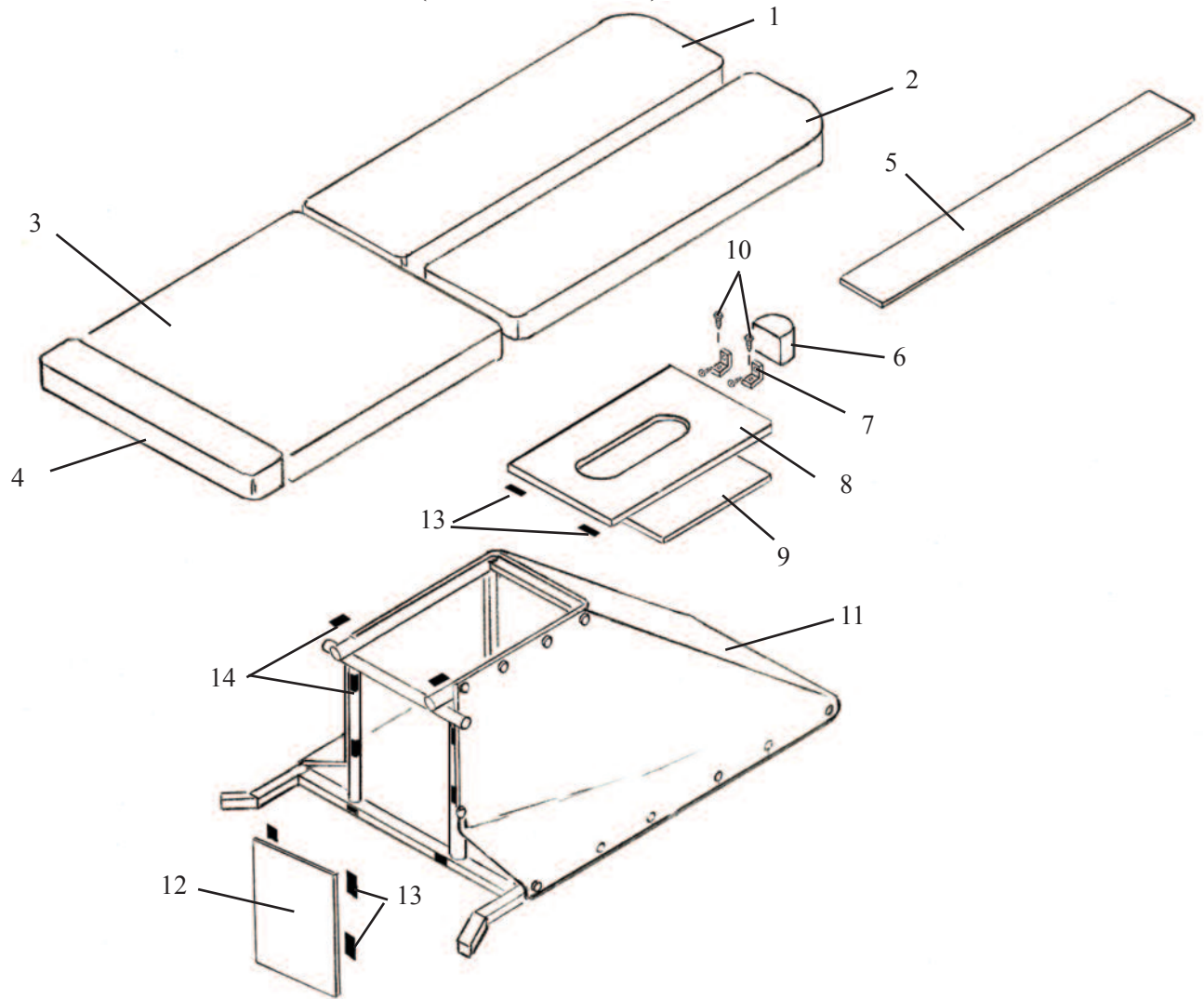

ITEM	PART NO.	DESCRIPTION	QTY.
698600 CUSHION SET			
1	40212	BODY CUSHION (LH)	1
2	40213	BODY CUSHION (RH)	1
3a	40214	PELVIC CUSHION (STD.)	1
3b	40216	PELVIC CUSHION (wedge)	1
4	40215	ANKLE REST CUSHION	1
5	40371	BIB COVER	1
699201 COVER SET			
6	699204	SWITCH CAP	1
7	35195	L-BRACKET	2
8	699202	TOP COVER PLATE	1
9	40704	FOAM COVER	1
10	22460	PAN HD SCREW, #10 X ½	2
11	40359	NAUGAHYDE COVER	1
12	699207	BACK COVER PLATE	1
13	28551	VELCRO LOOP, 1 X 2"	8
14	28552	VELCRO HOOK, 1 X 2"	8

Activator Hylo w/M&W New Block GE Motor & Poppet Valve Wiring & Switches (Non ATF w/New Electrical Unit)

The Front Sequence Switch under the cup (Switch A) and the Rear Sequence Switch under the pelvic (Switch B) work in unison to insure that the table cannot be tilted until the Footplate has been extended. The Front Sequence Switch is activated whenever the table is in the horizontal position. Before the table can be tilted from horizontal the Footplate Slide Rod first moves rearward to extended the Footplate and activate the Rear Sequence Switch. The table then begins tilting and continues to tilt as long as the Rear Sequence Switch remains activated. The table will continue to tilt until the Tilt Limit Switch is activated which shuts off the motor.

The Front Switch under the pelvic (Switch C) is activated by the Footplate Slide Rod when the table has reached the horizontal position and the Footplate drops down. This shuts off the motor.

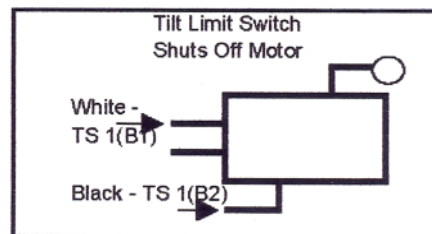
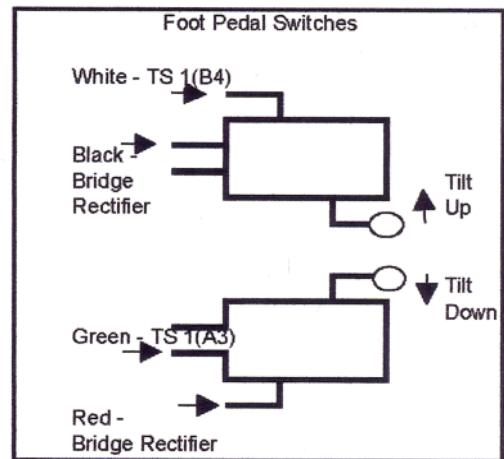
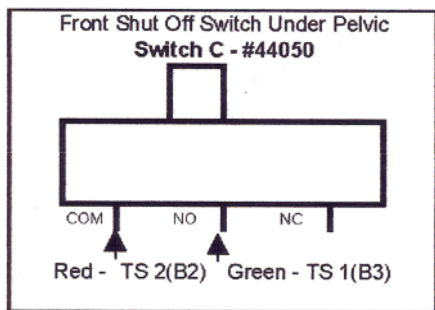
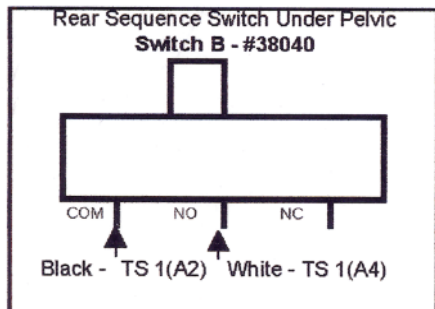
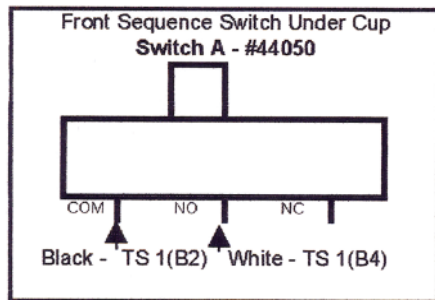

Activator Hylo w/M&W New Block GE Motor & Poppet Valve Wiring & Switches (Non ATF w/New Electrical Unit)

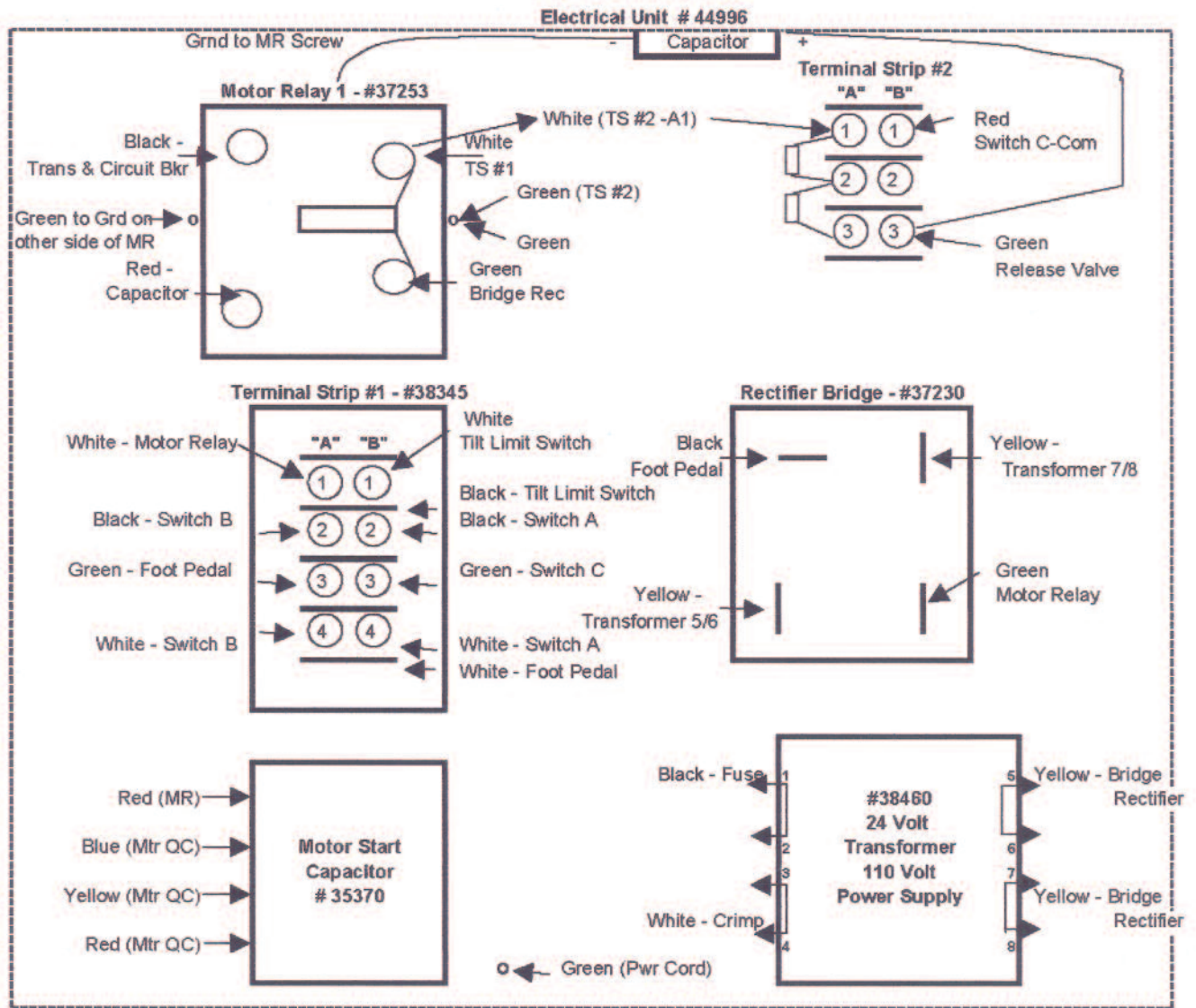

2-Position
4-Way Valve

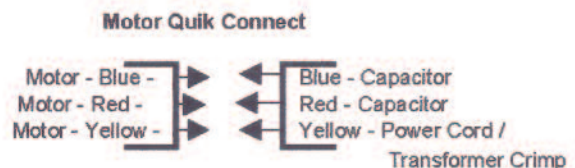
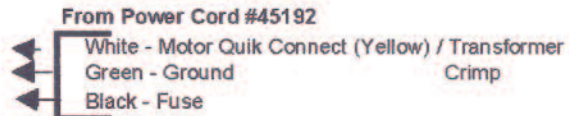
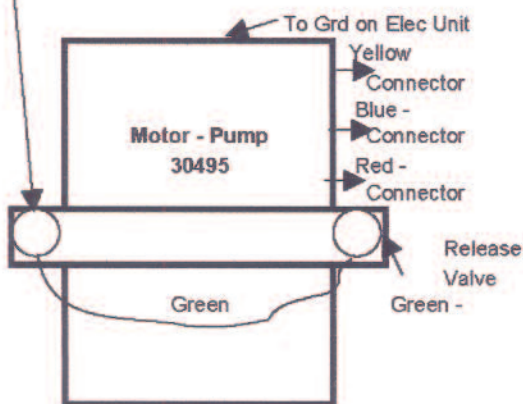

Activator Hylo w/M&W New Block GE Motor & Poppet Valve w/Automatic Tilt Feature (ATF) Wiring & Switches

The Front Sequence Switch under the cup (Switch A) and the Rear Sequence Switch under the pelvic (Switch B) work in unison to insure that the table cannot be tilted until the Footplate has been extended. The Front Sequence Switch is activated whenever the table is in the horizontal position. Before the table can be tilted from horizontal the Footplate Slide Rod first moves rearward to extend the Footplate and activate the Rear Sequence Switch. The table then begins tilting and continues to tilt as long as the Rear Sequence Switch remains activated. The table will continue to tilt until the Tilt Limit Switch is activated which shuts off the motor.

The Front Switch under the pelvic (Switch C) is activated by the Footplate Slide Rod when the table has reached the horizontal position and the Footplate drops down. This shuts off the motor.

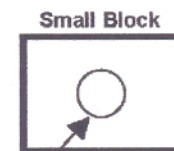
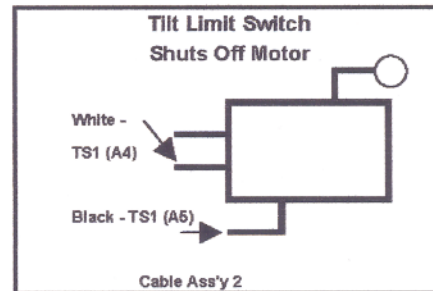
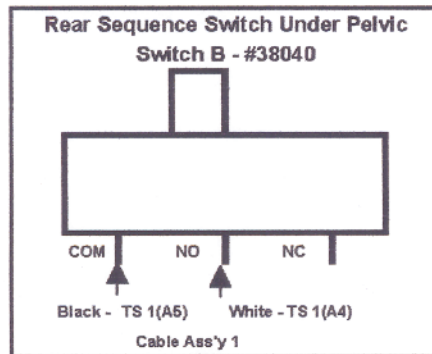
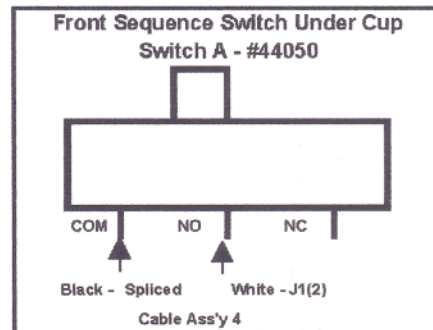
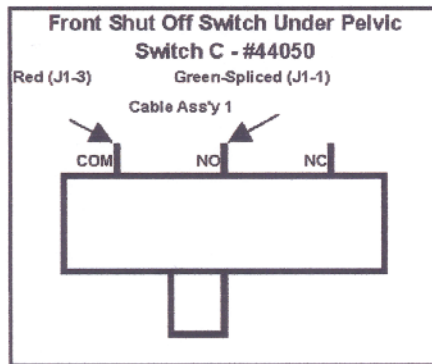

White - Mtr Relay Double Poppet Valve

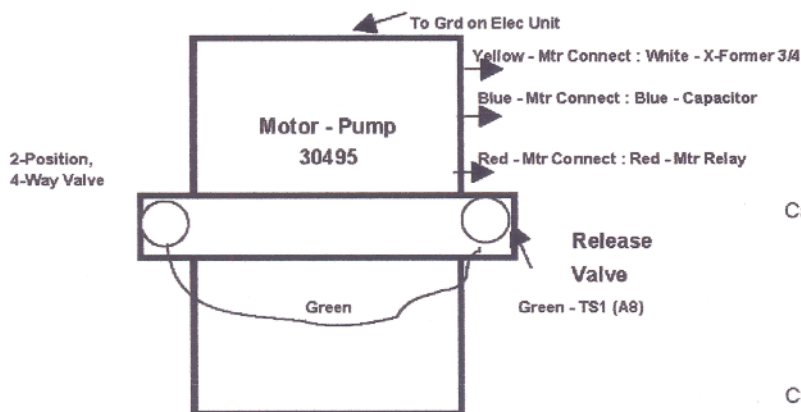

Cable Ass'y 1
Red - Front Shut Off Switch under Pelvic to J1(3)
Green - Front Shut Off Switch under Pelvic to Splice
Black - Rear Sequence under Pelvic to TS1(A5)
White - Rear Sequence under Pelvic to TS1(A4)

Cable Ass'y 2
White - Tilt Limit Switch to TS1(A4)
Black - Tilt Limit Switch to TS1(A5)

Cable Ass'y 3 (Flex EHA Auxilliary Board)

Cable 4
White - Front Seq Switch under Cup to J1(4)
Black - Front Seq Switch under Cup to Splice

Splice - Cable 1 Green w/Cable 4 Black w/J1(1)

